

Door installation

To install, place the hinge on the mounting plate and push the back of the hinge arm down with finger pressure. The “click” sound confirms a secure attachment.

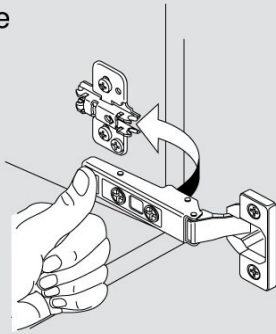

Door removal

Release the lever under the hinge arm to remove.

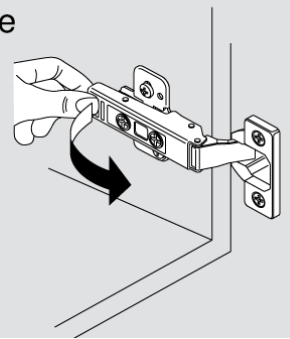

Side adjustment

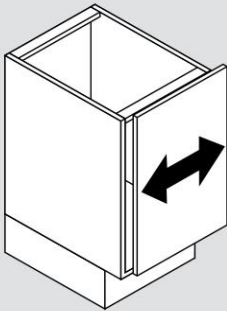

Rotate the front screw to increase or decrease the door overlay (+/- 2 mm).

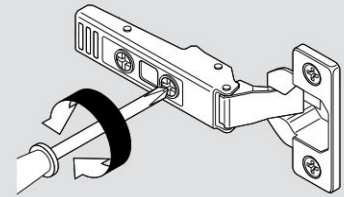

Face frame cam adapter plate

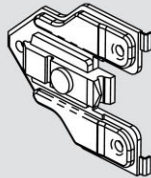
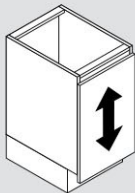

Rotate cam screw on the mounting plate to adjust door position (+/- 2 mm).

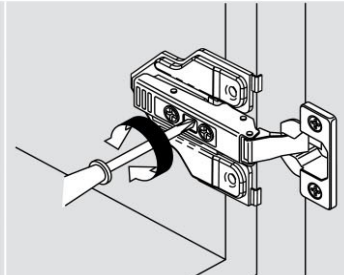

Depth adjustment

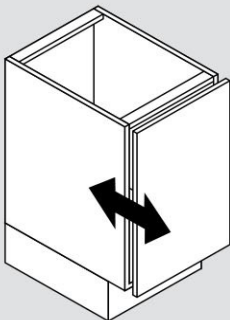

Rotate the rear spiral tech cam screw to adjust the door position (+ 3/- 2 mm).

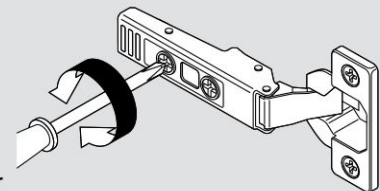

For CLIP hinges, loosen the rear screws on all hinges, adjust and retighten.